

- Line of Superseam tray under cricket
- TRS Superseam™ back trays
- Top of cricket flashing backtray. 15mm hem
- Cricket flashing when required

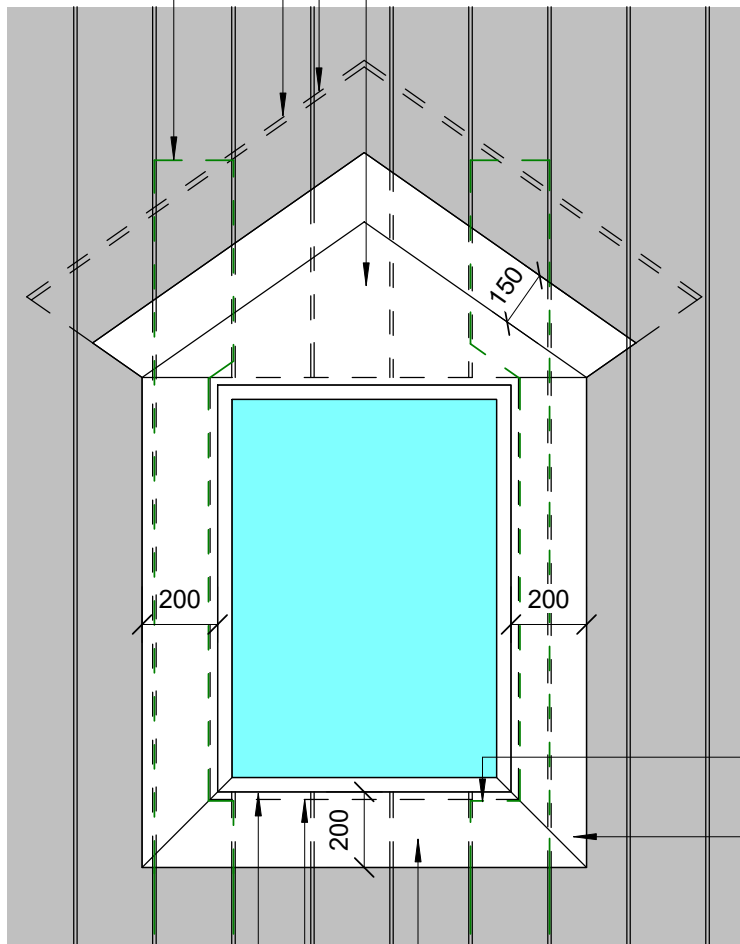

Under flashing fixed to purlins

Side apron

Front apron

Stop ends to Superseam™

TRS Superseam™ upstand 40mm

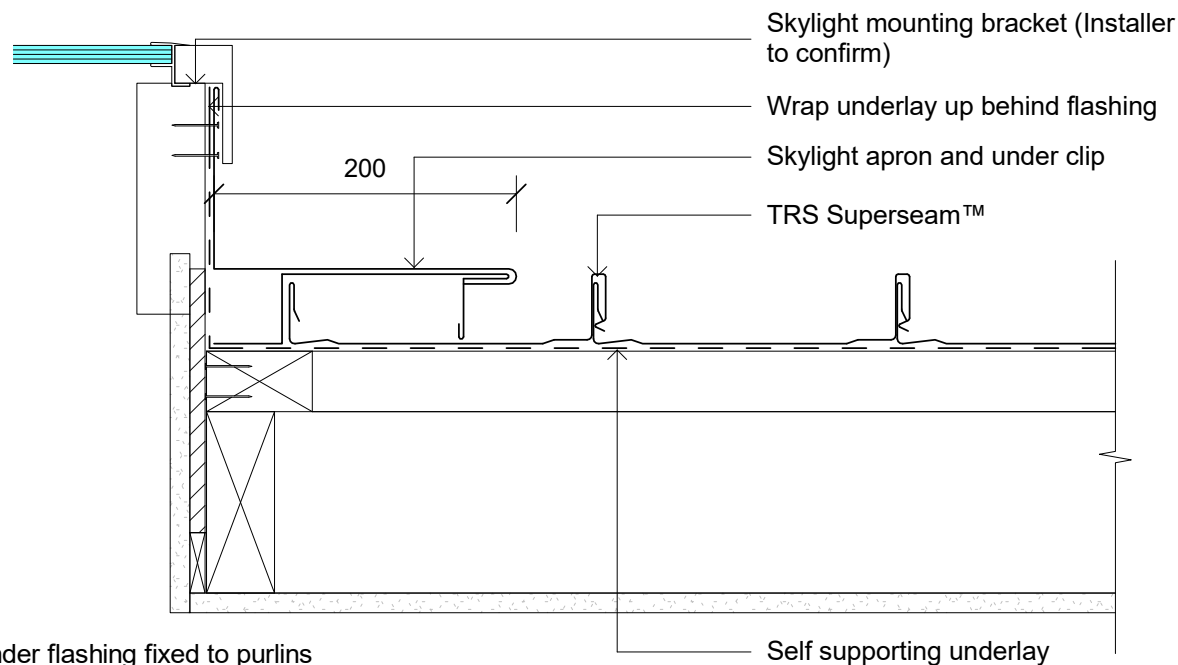

- These details are generally in accordance with E2/AS1 and or the NZ metal roof & wall cladding code of practice.
- The building designer/ Architect is ultimately responsible for details to meet the NZ Building Code & E2/AS1.
- For Further information please contact your nearest roofing store [www.theroofingstore.co.nz](http://www.theroofingstore.co.nz).