

# PRODUCT INFORMATION SHEET

## VENT OVER FASCIA VENTS

### G1200N & G2500N

#### DESCRIPTION

The VENT G1200N and G2500N Over Fascia Vents are designed to discreetly ensure a calculated free flow of air into the roof space between the roof membrane and the fascia board.

#### FEATURES

Vent Over Fascia Vents provide free airflow of 25,000mm<sup>2</sup> and 10,000mm<sup>2</sup> per linear metre.

- G2500N = 25,000mm<sup>2</sup> per linear metre or 1/150
- G1200N = 10,000mm<sup>2</sup> per linear metre or 1/300
- Allows hot air to escape the roof void and manages condensation
- Easy to install
- Not visible as hidden by spouting/gutter
- The only solution to ventilate builds with no eaves
- Insect proof - 4mm vents prevent ingress of nesting insects

#### SCOPE OF USE

- In accordance with BS5250
- G1200N - Suitable for roof pitches >15°
- G2500N - Suitable for pitches <15° and any degree skillion roof
- Compatible with timber or metal fascia
- Suitable for new builds or renovations
- Should be used in conjunction with the VENT Roll Panel Vent/Insulation Guard/Eaves Baffle (G502) for traditional roof types, to ensure continuous and unimpeded airflow past the insulation
- To be used as part of a proprietary ventilation system

#### WARRANTY

- 15 years

#### MAINTENANCE

- No maintenance requirements

#### CONDITIONS & LIMITATIONS

- G1200N/G2500N Over Fascia Vents must be installed in accordance with product installation guide
- G1200N/G2500N Over Fascia Vents can installed on both timber or steel roof and wall framing
- G1200N/G2500N Over Fascia Vents are suitable for use with any synthetic or bitumen based underlays
- G1200N/G2500N Over Fascia Vents are suitable for use under, but not limited to masonry tiles, terracotta tiles, metal tiles, profiled metal claddings, slate and composite claddings

#### INSTALLATION

1. The VENT G2500N & G1200N Over Fascia Vents should be screw fixed (for metal fascia) or nail fixed (for timber fascia) to the top of the fascia board through the fixing holes provided along the full length of the eaves as shown
2. Ensures screws meet metal fascia manufacturers warranty requirements  
- We recommend the use of Armagalve fixings
3. The Over Fascia Vents butt up to each other along the entire run of fascia
4. The Over Fascia Vents are placed on top of the fascia and under the building membrane
5. The G2500N Over Fascia Vent should be installed with an eaves flashing above, please refer to DriSpace/VENT technical details
6. VENT Over Fascia Vents may require adjustments to fascia or roof heights depending on the type of Over Fascia Vent, the type of fascia and/or combination of vent products being installed
7. VENT Over Fascia Vents should not be exposed to direct sunlight for more than 30 days

#### STORAGE

- Handling and storage of the VENT Ventilation products, whether on-site or off-site, is under the control of the building contractor. Roof Ventilation Products must be protected from direct sunlight and physical damage, and should be stored flat and under cover.

#### SPECIFICATIONS

G2500N Dimensions	1000mm L x 32mm H
G1200N Dimensions	1000mm L x 17mm H
Colour	Black
Material	Polyethylene
Box Quantity	20mm x 1000mm (20m)

# PRODUCT INFORMATION SHEET

## VENT OVER FASCIA VENTS

### G1200N & G2500N

Fig A: Application of G2500N, roof pitch <math><15^\circ</math>

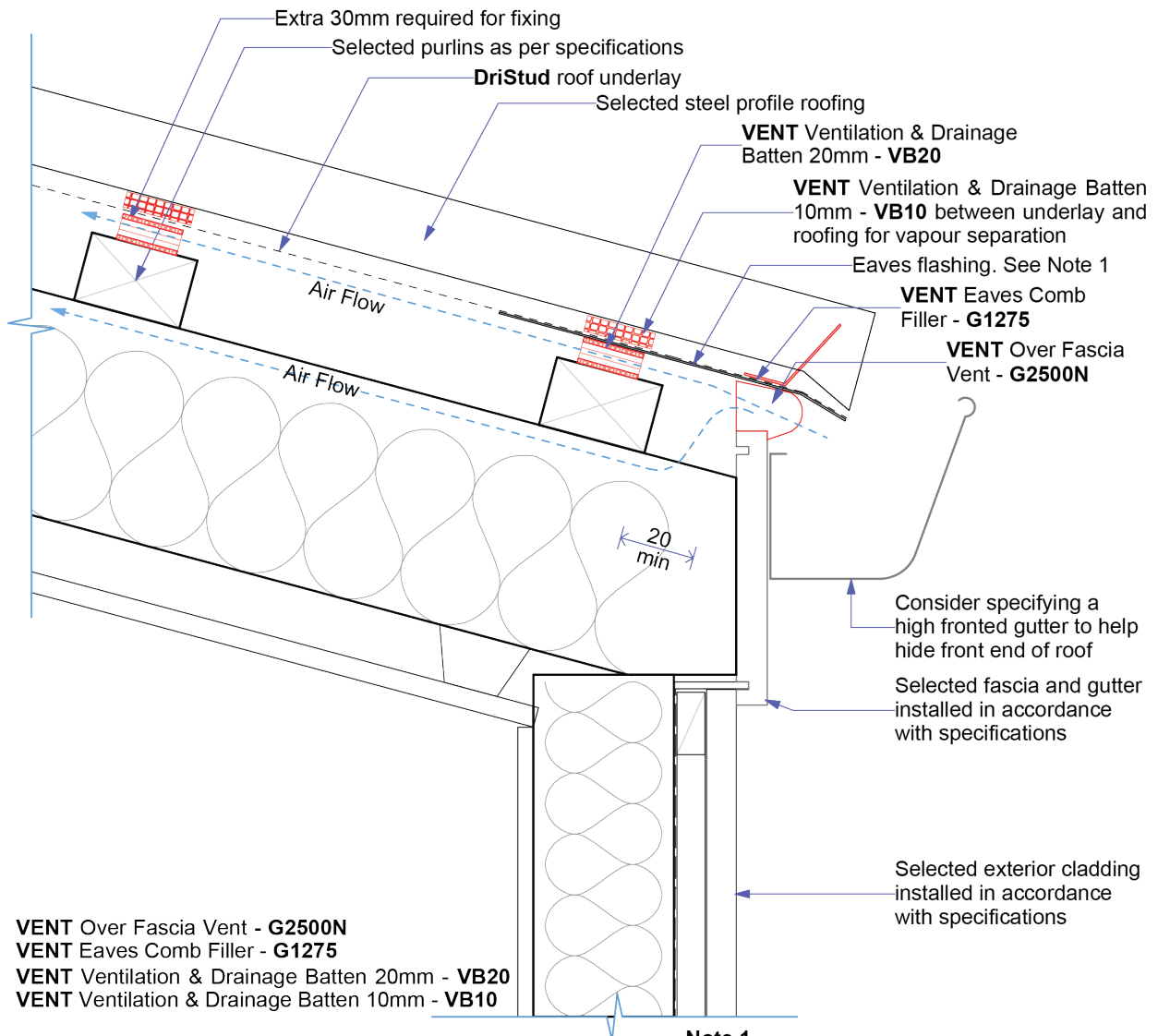

**VENT Over Fascia Vent - G2500N**  
**VENT Eaves Comb Filler - G1275**  
**VENT Ventilation & Drainage Batten 20mm - VB20**  
**VENT Ventilation & Drainage Batten 10mm - VB10**

**PROFILED STEEL ROOF CLADDING**  
 Ventilated Fascia - Skillion Roof No Eave  
 (25,000mm<sup>2</sup> lin/m)

A minimum of 20mm gap between the bottom purlin and Over Fascia Vent must be maintained to allow air flow into roof cavity

**Note 1**

Eave flashing required where all of the following conditions are met

- Roof pitch less than 10° and,
- Soffit width less than or equal to 100mm and,
- Wind zone is Very High or greater.

Consider specifying a high fronted gutter to help hide front end of roof

Selected fascia and gutter installed in accordance with specifications

Selected exterior cladding installed in accordance with specifications

# PRODUCT INFORMATION SHEET

## VENT OVER FASCIA VENTS

### G1200N & G2500N

Fig B: Product Dimensions

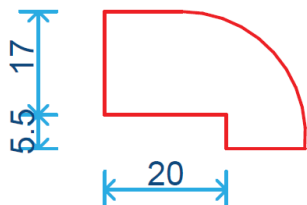

VENT - Over Fascia Vent - G1200N

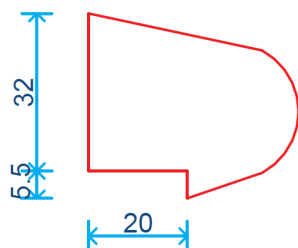

VENT - Over Fascia Vent - G2500N

VENT - Over Fascia Vent - G1200N



VENT - Over Fascia Vent - G2500N



Fig C: Application of G1200N for trussed roof, roof pitch >15°

